

## PART 7.55 – S-10-CP ZONE, SERVICES CLOVER POINT DISTRICT

### 7.55.1 Definitions

In this Part 7.55,

“**open space**” means that portion of the zoned area which is landscaped and not occupied or obstructed by any building or portion of building, driveway or parking lot.

“**wastewater pump station**” means a building or structure used to collect, screen and pump wastewater effluent, but does not include wastewater treatment.

“**zoned area**” means all public right-of-way shown on the map attached as Appendix A.

### 7.55.2 Permitted Uses in this Zone

The following uses are the only uses permitted in this Zone:

- a. Wastewater pump station
- b. Public building subject to the regulations in Part 1.2
- c. Accessory buildings subject to the regulations in Schedule “F”

### 7.55.3 Floor Area, Floor Space Ratio

Floor area of a wastewater pump station (maximum)	1800m <sup>2</sup>
---	--------------------

### 7.55.4 Height, Storeys

- |                                     |                       |
|-------------------------------------|-----------------------|
| a. <u>Building height</u> (maximum) | 12.60m above Geodetic |
| b. <u>Storeys</u> (maximum)         | 0                     |

### 7.55.5 Setbacks

Setback of <u>building</u> from the high water mark (minimum)	4m
---	----

### 7.55.6 Zoned Area Open Space

Open space (minimum)	60%
----------------------	-----

## PART 7.55 – S-10-CP ZONE, SERVICES CLOVER POINT DISTRICT

### 7.55.7 Vehicle and Bicycle Parking

- |                                      |  |
|--------------------------------------|--|
| a. <u>Vehicle parking</u> (minimum)  | Subject to the regulations in Schedule “C” except as otherwise specified by the regulations in this Part |
| b. Wastewater pump station (minimum) | Nil  |

Adopted February 23, 2017

PART 7.55 – S-10-CP ZONE, SERVICES CLOVER POINT DISTRICT

Appendix A

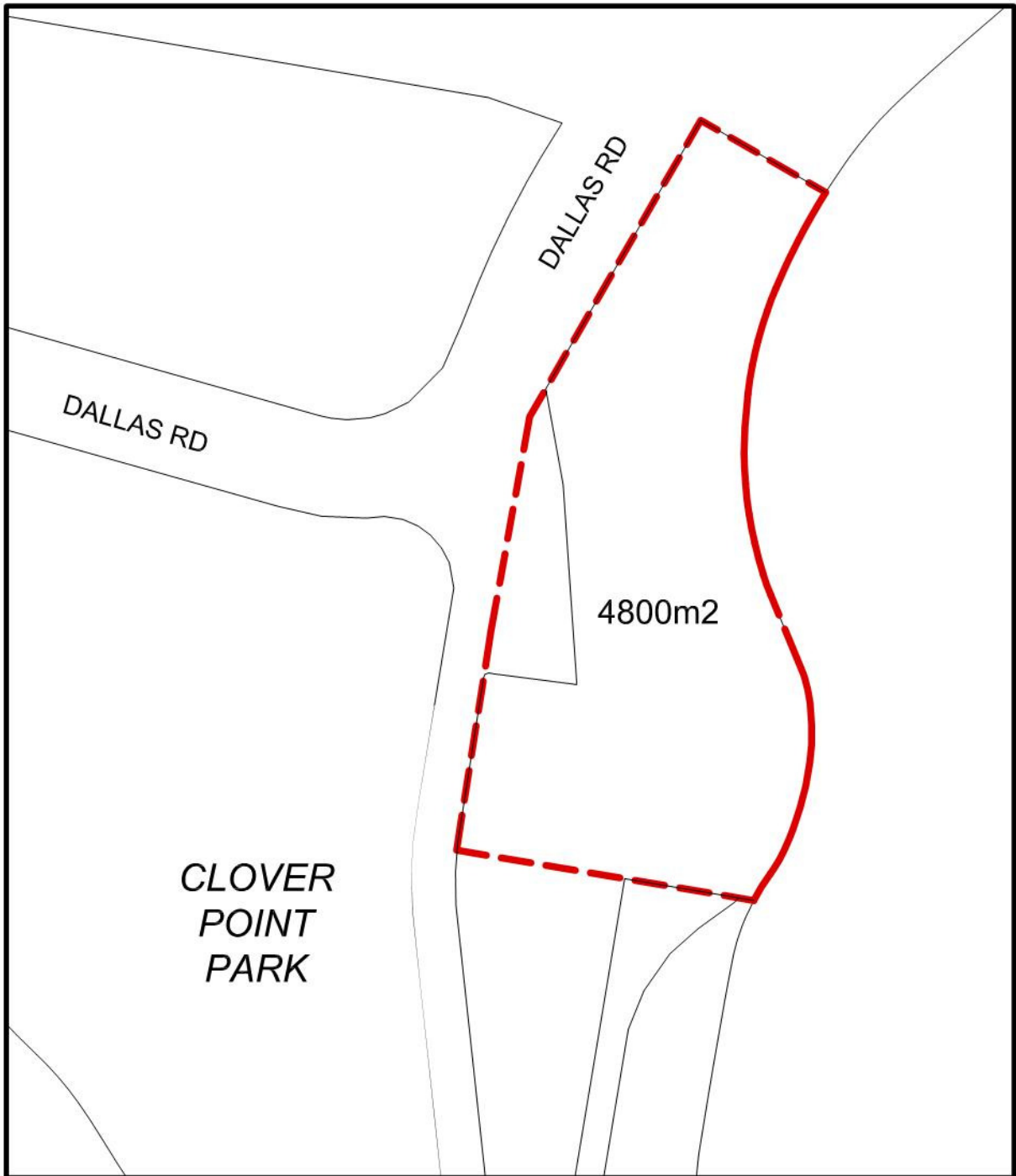

Appendix A  
Zoned Area  
Service Clover Point



Words that are underlined see definitions in Schedule "A" of the Zoning Regulation Bylaw